

MITRA APARTMENT

BY

**SUBIKASH
CONSTRUCTION**

A series of several parallel white lines of varying thicknesses, slanted diagonally from the bottom left towards the top right, crossing the right side of the text.



*PROPOSED ELEVATION OF G+IV
RESIDENTIAL CUM COMMERCIAL
BUILDING MITRA APARTMENT.*

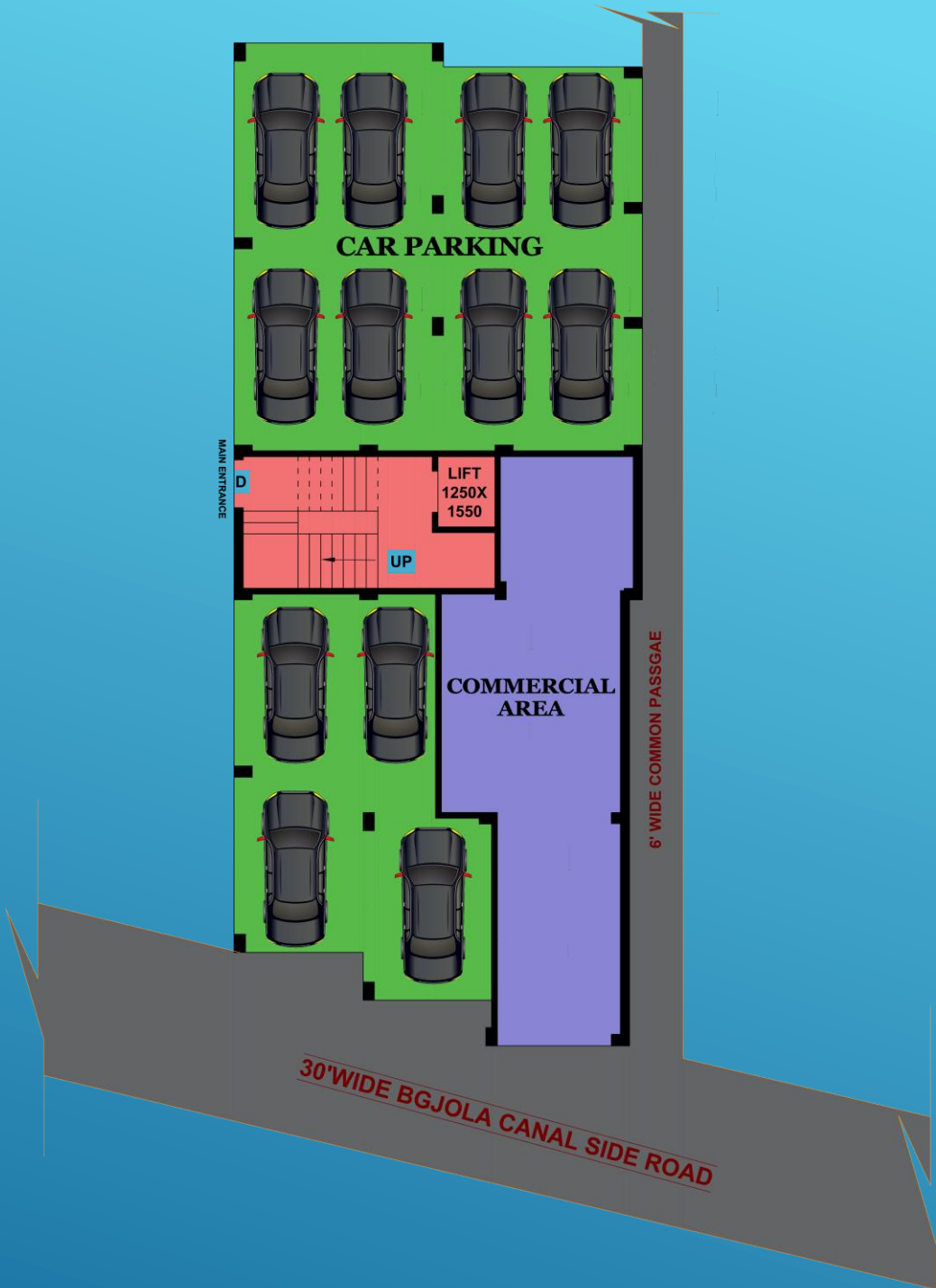

GROUND FLOOR PLAN



- FLAT A
- FLAT C
- FLAT B
- FLAT D
- COMMON AREA

TYPICAL FLOOR PLAN (1ST-4TH)



PROPOSED 3D VIEW OF FLAT TYPE-A



PROPOSED 3D VIEW OF FLAT TYPE-B



PROPOSED 3D VIEW OF FLAT TYPE-C

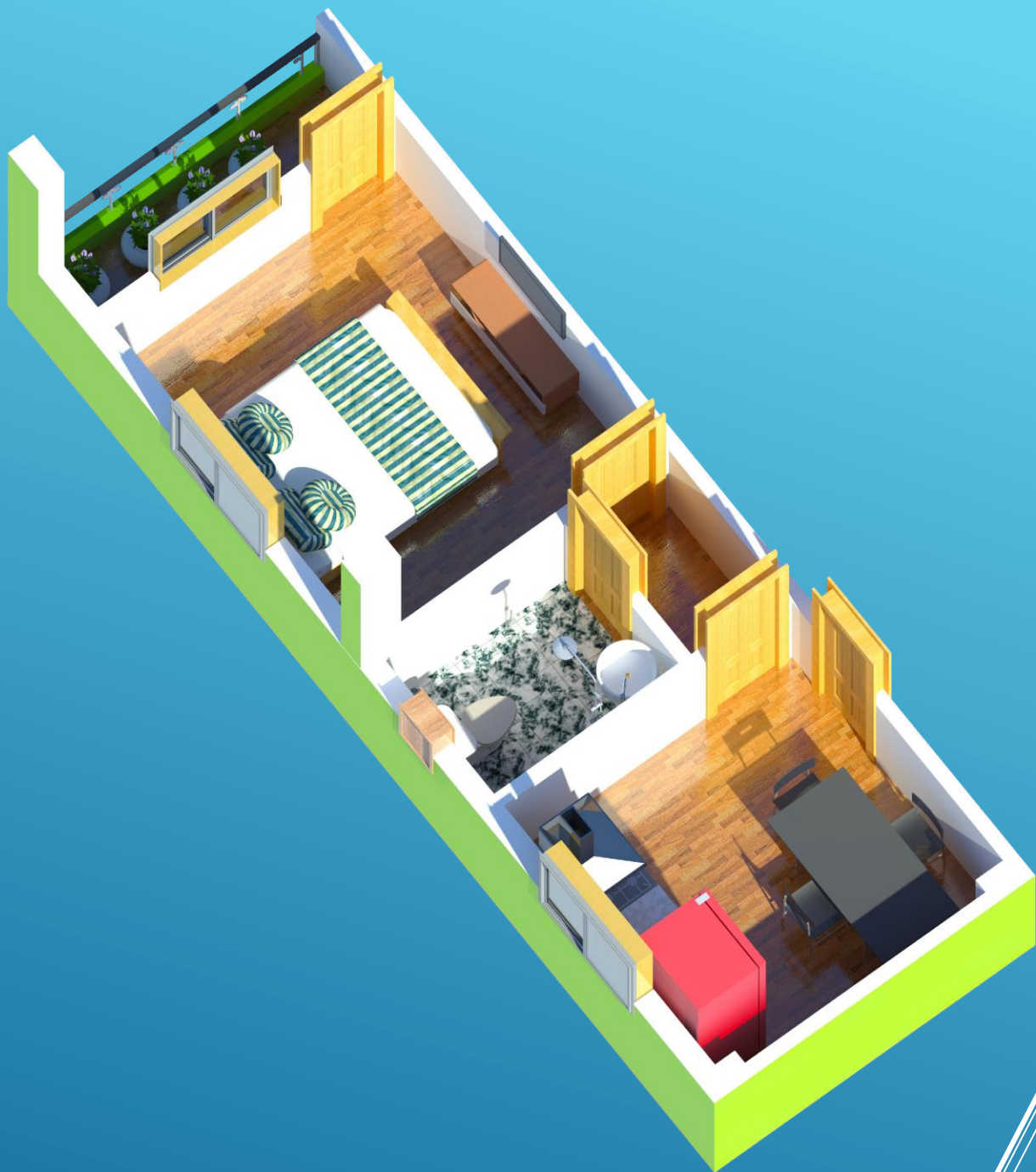

PROPOSED 3D VIEW OF FLAT TYPE-D

★ SALT LAKE CITY

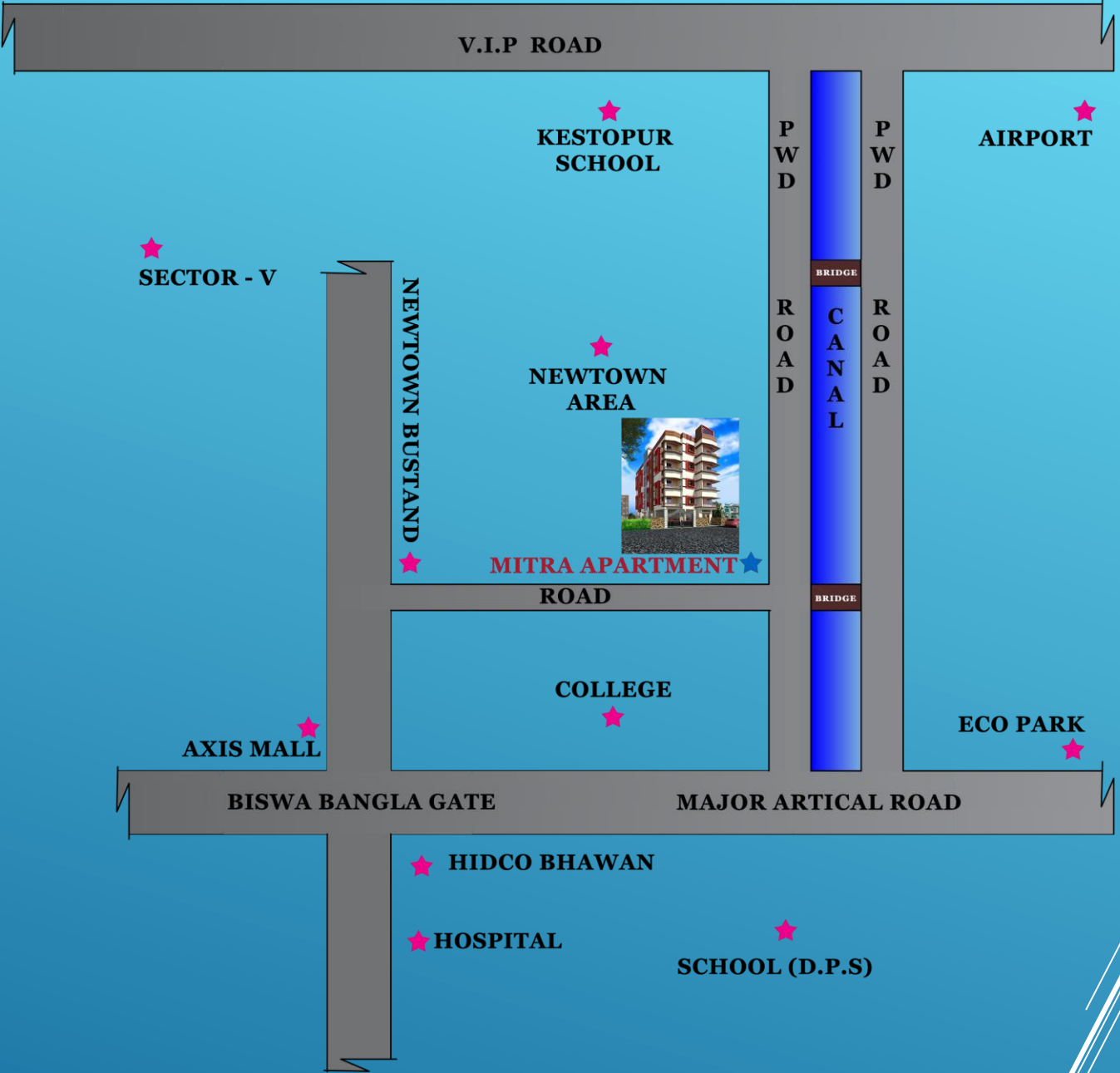

LOCATION PLAN



FACILITIES

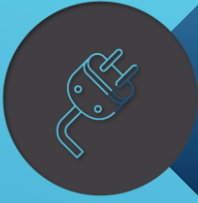

24HRS POWER BACKUP



24HRS WATER SUPPLY



24HRS SECURITY SERVICE



LIFT FACILITY



PARKING SPACE FACILITY



WELL DEFINED
COMMUNICATIONS



EASY ACCESS TO SCHOOL,
COLLEGE, MALL, HOSPITAL,
AIRPORT, AMUSEMENT PARK.

BOOKING GOING ON

CONTACT

SUBIKASH CONSTRUCTION

MR. MAQBOOL HASSAN

BADAMTALA, RAJARHAT

NEAR CHOUMATHA, SHOP NO. 8,

KOLKATA-700135

N24 PGS

PH.NO.- 9874405534

Loan Facilities

LIC HOUSING FINANCE

STATE BANK OF INDIA

THANK YOU

HAVE A NICE DAY!

WE HOPE YOU
HAVE
APPRECIATED
OUR PROJECT.